

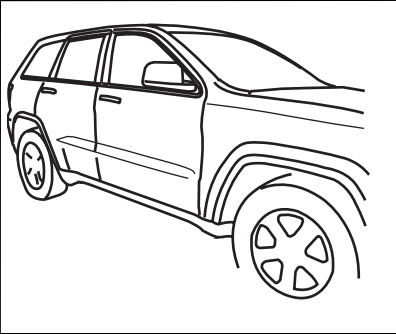

# JEEP GRAND CHEROKEE

TUBULAR SIDE STEPS  
EL LADO TUBULAR DA UN PASO  
LES ETAPES LATERALES TUBULAIRES



M6



**A** 12x



**B** 6x

M8



**C** 6x

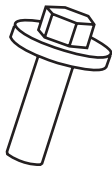

**D** 6x



**E** 12x

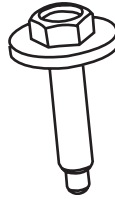

**F** 12x

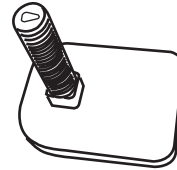

**G** 6x

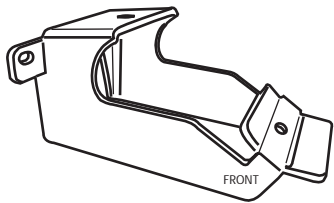

**H1** 2x

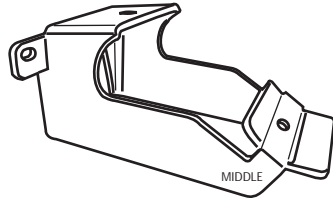

**H2** 2x

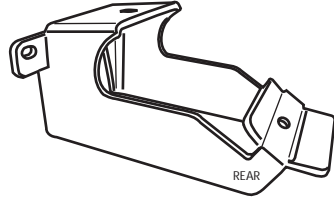

**H3** 2x



REAR  
TRASERO  
ARRIERE

PASSENGER'S SIDE  
LADO de PASAJERO  
COTE DU PASSAGER

FRONT  
FRENTE  
DEVANT

**I** 2x

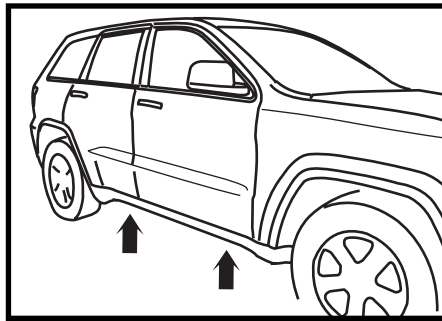
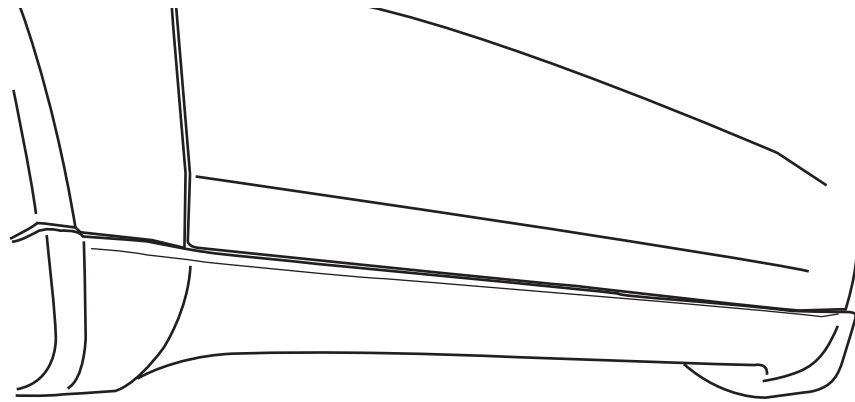

1

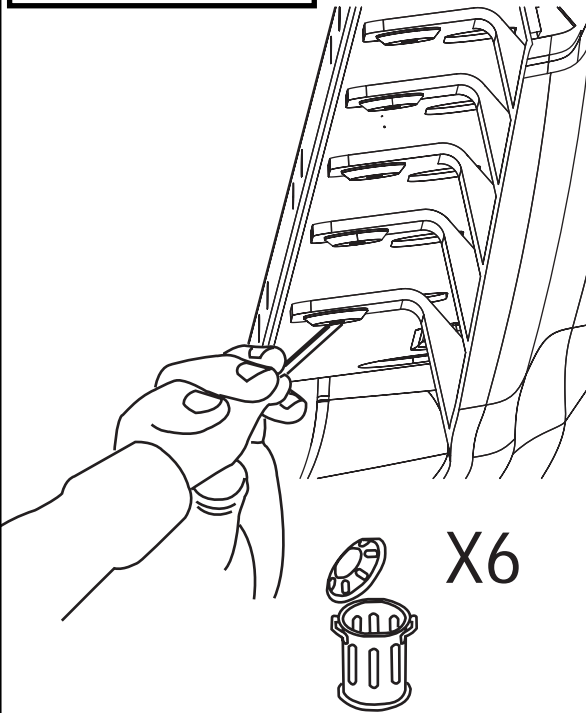
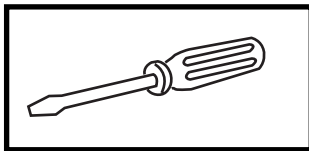

2

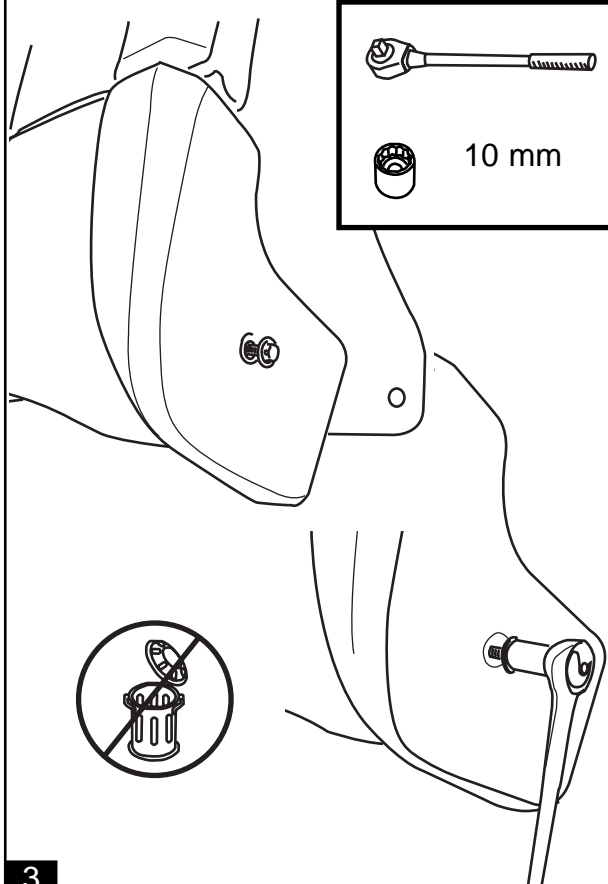
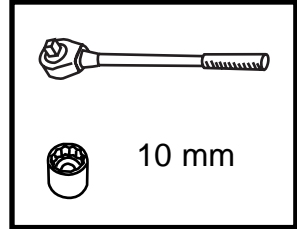

3

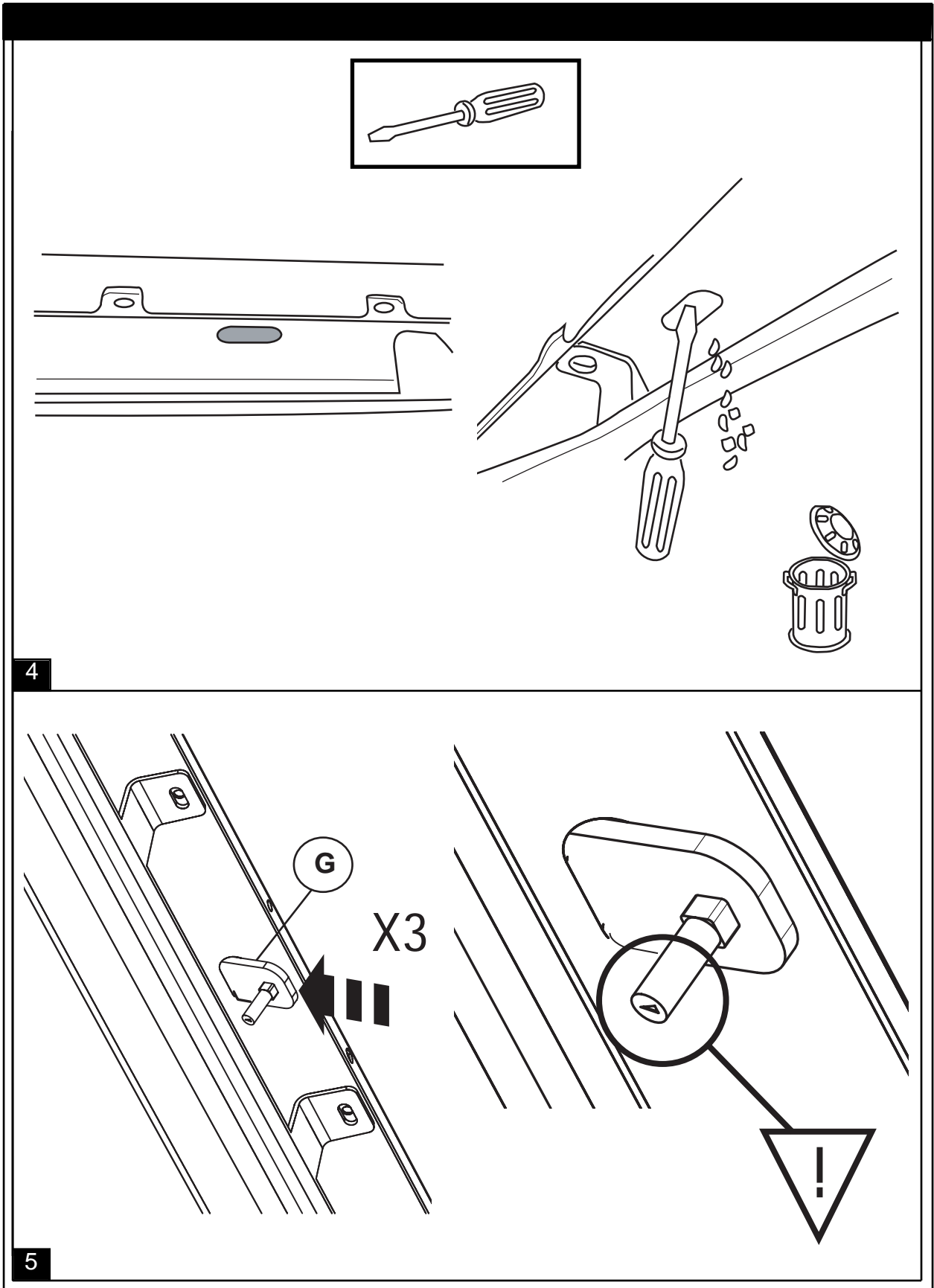

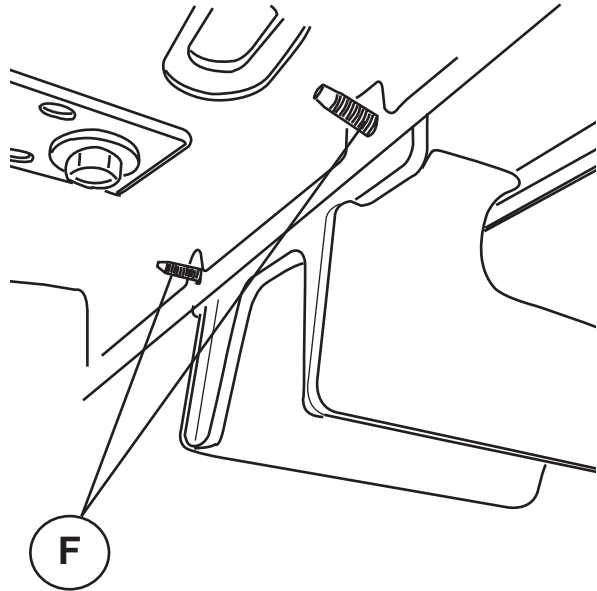
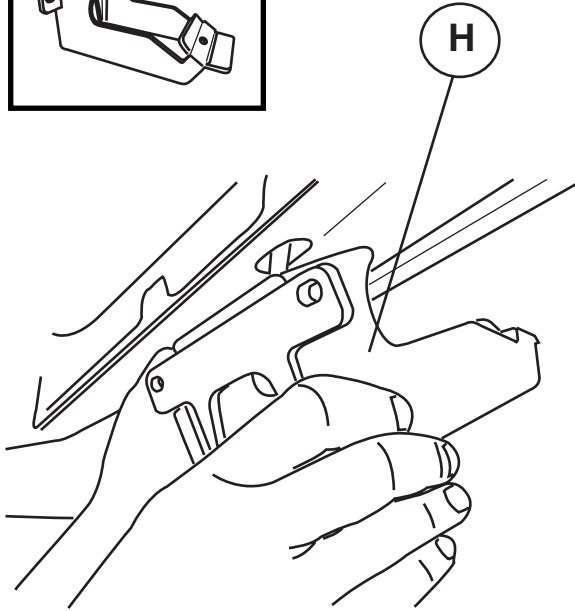
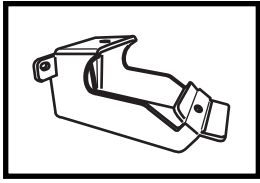

6

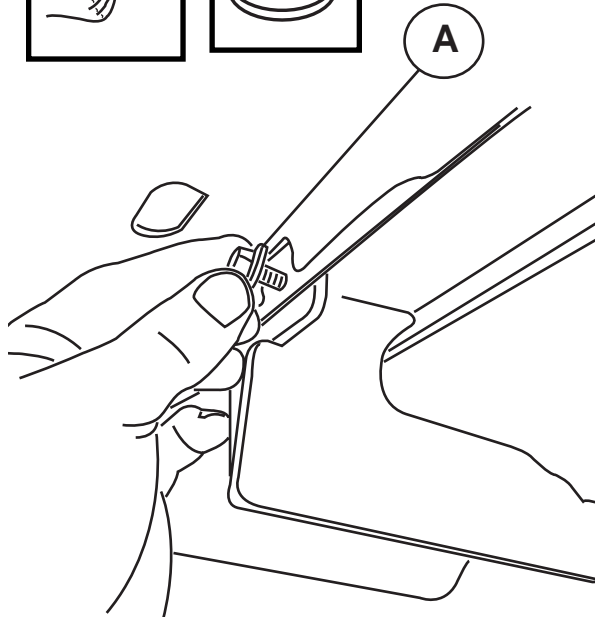
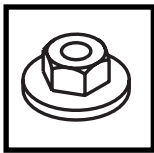

10 ft-lbs (120 in-lbs)

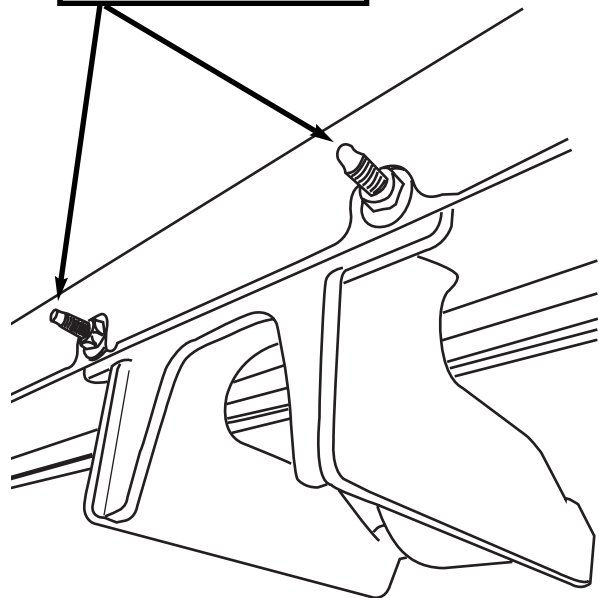

7

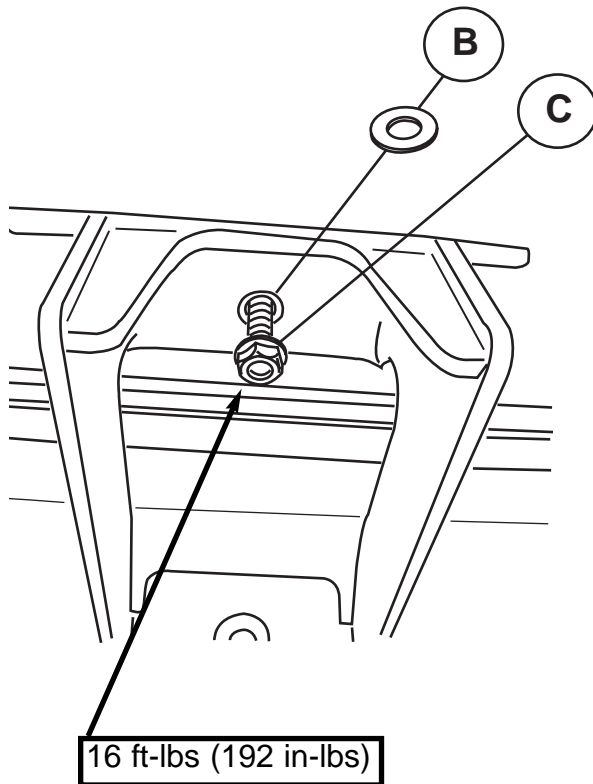

8

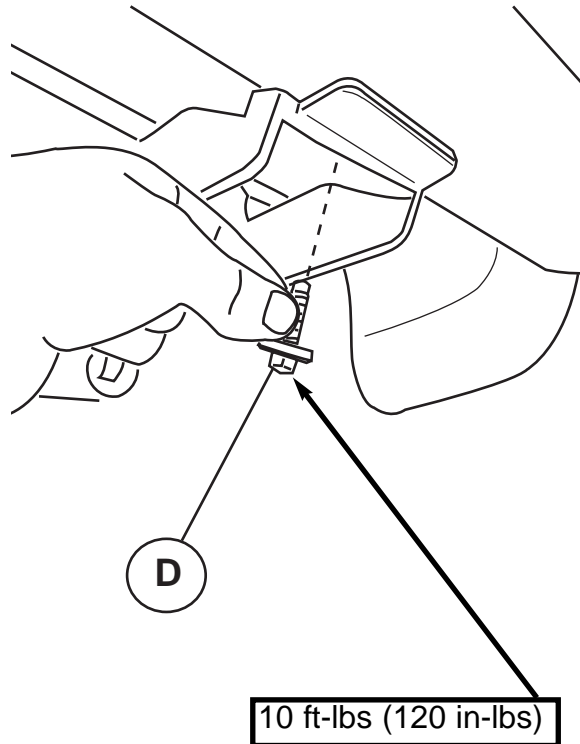

9

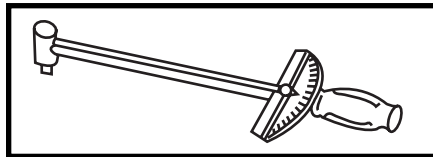

Tighten all M8 fasteners to 16 ft-lbs. (192 in-lbs.) (22 N.m). Tighten all M6 fasteners to 10 ft-lbs. (120 in-lbs.) (13.5 N.m). Repeat for Driver's side.  
CAUTION - Do Not Over-torque

Apriete todos M8 clerres a 16 ft-lbs. (192 in-lbs.) (22 N.m). Apriete todos M6 clerres a 10 ft-lbs. (13.5 N.m). (120 in-lbs.) Repita el lado de pasajero.  
Precaución: No apriete demasiado

Resserrer tous M8 fermoira pour 16 ft-lbs. (192 in-lbs.) (22 N.m). Resserrer tous M6 fermoira pour 10 ft-lbs. (120 in-lbs.) (13.5 N.m). Répéter pour le côté du chauffeur.  
Attention: Ne pas surcoupler

10

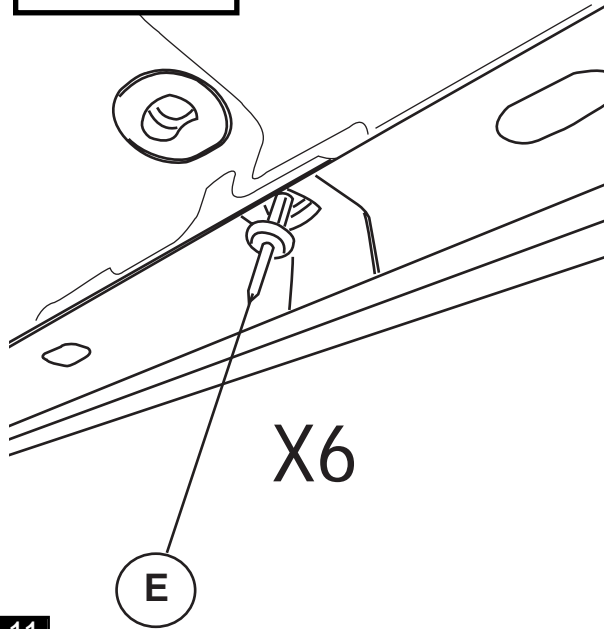
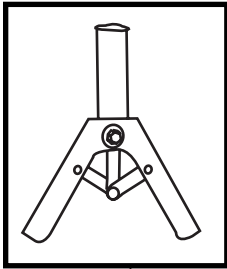

11

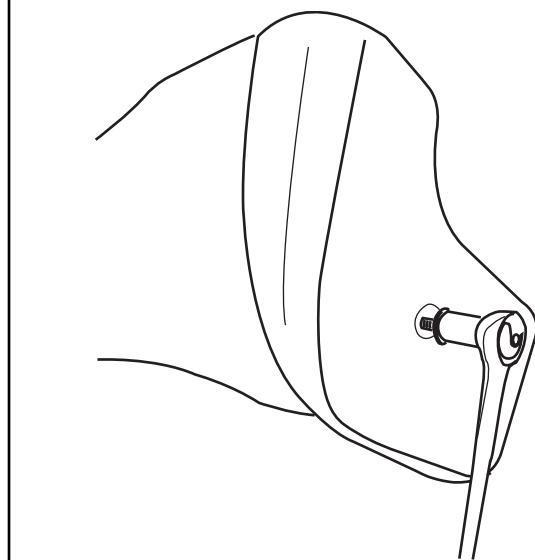
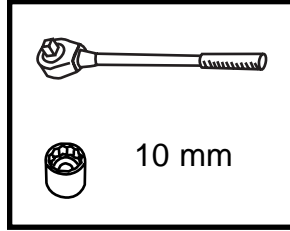

12

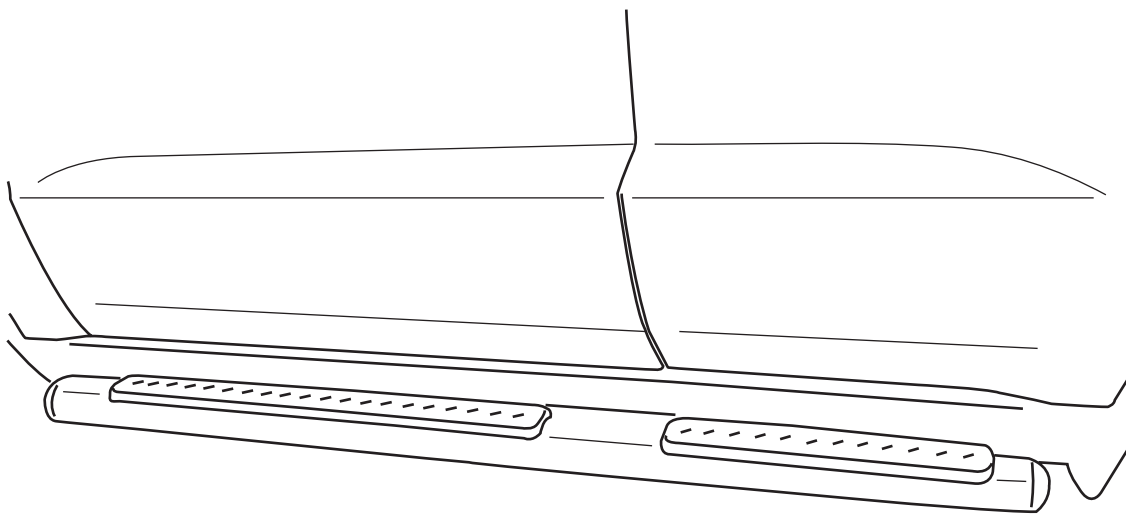

13